

Smart Wi-Fi+BLE Light Switch User Manual



Notes Before Installation

- 1.Wi-Fi only support a 2.4GHz network (802.1 b/g/n)
- 2.Only support one way/single pole circuit, not compatible with 2-way.
- 3.With Neutral wire or without Neutral wire.
- 4.This product has no relay function.
- 5.Basic electrical wiring knowledge or experience is required , or please consult to a profesional electrician, pay attention to power-off installation.
- 6.ON/OFF button also can be used as reset button. Long press any key for 10 seconds to reset your smart switch to factory defaults only do this if you are sure you want to erase all your settings.

1

Functional features:

1. Ultra-low power consumption. The power consumption of the switch itself is less than 0.05W
2. The switch has a timing function, which can be set to open or close at a certain time.
3. Power-on state setting function

(1) Power failure. The switch is always turned off when power is turned on after power failure.

(2) Power on, the switch is always on when power is turned on after power failure.

(3) Power-off memory: every time the power is cut off and then energized, the switch always remembers the state before the power is cut off.

4. Indicator light control function

(1) Turn off the indicator light. No matter whether the switch is on or off, the indicator light is off.

(2) The indicator light indicates the state of the switch. When the switch is turned on, the indicator light is turned off, and when the switch is turned off.

(3) The indicator light indicates the position. When the switch is turned on, the indicator light is turned off, and when the switch is turned off, the indicator light is turned on.

5. Multi-control correlation function.

6. Intelligent voice speaker control functions, such as Amazon speaker, Google speaker, etc.

2

1.Download App and Register

1.1 How to download App?

Scan the QR code below or search for "Haiz Smart" in the IOS APP store or Google play.



IOS & Android System

3

1.2 SettingHaiz Smart APP, How to Register and Login?

Download or Scan the QR Code and install Haiz Smart App. Once download or Scan the QR Code, register your account.

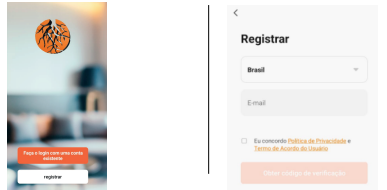

1.3Enter your phone number or email which you prefer and select the country you live in.

Obtain verification code. → Enter verification code.
→ Set Password.



4

1.4 Create "Family"

Enter the family name and select the room. Family created sucessfully.

5

2. Wiring Diagram

Please select the wiring method according to the actual situation.

Note: Disconnect the power supply before wiring.

2.1 EU switch wiring method.

2.1.1 Neutral wire is required on the switch according to the following diagram wiring.

1-Neutral wire.

2-Live wire.

3-Switch.

4.5.6.7-Lighting,They're between L1,L2,L3,L4 and Neutral wire.

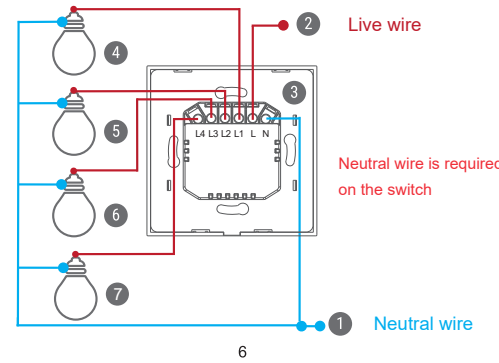

2.1.2 No neutral wire is required on the switch according to the following diagram wiring.

1-Neutral wire.

2-Live wire.

3-Switch.

4-Capacitor,it must to be connected to L1 and Neutral wire.

5.6.7.8-Lighting,They're between L1,L2,L3,L4 and Neutral wire.

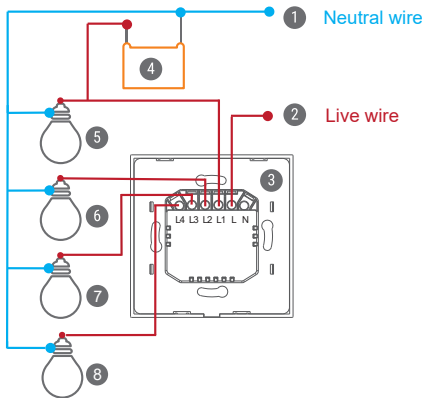

7

2.2 US touch switch wiring method.

2.2.1 Neutral wire is required on the switch according to the following diagram wiring.

1-Neutral wire.

2-Live wire.

3-Switch.

4.5.6.7-Lighting,They're between L1,L2,L3,L4 and Neutral wire.

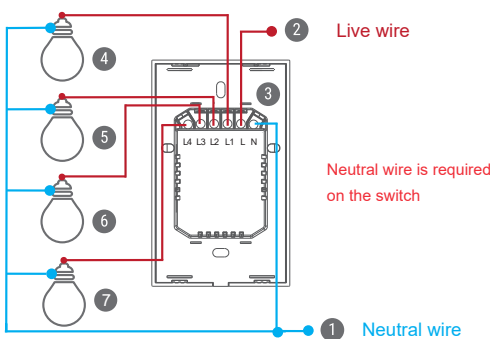

8

2.2.2 No neutral wire is required on the switch according to the following diagram wiring.

1-Neutral wire.

2-Live wire.

3-Switch.

4-Capacitor,it must to be connected to L1 and Neutral wire.

5.6.7.8-Lighting,They're between L1,L2,L3,L4 and Neutral wire.

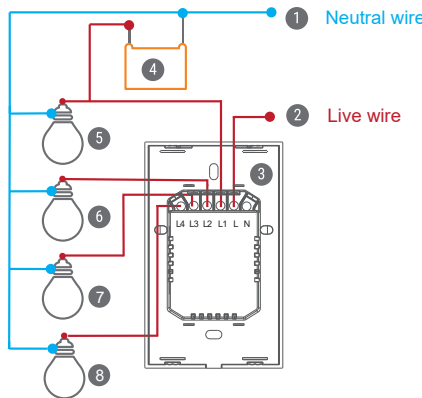

9

3. APP Pairing Switch

Bluetooth Mode (Default Setting)

3.1 Please turn on your phone's Bluetooth and Wi-Fi.

3.2 Power on the switch.The switch indicator light will automatically enter the fast flashing status when it is powered on.

Note:

- a. If the switch is not connected to the APP for 3 minutes, the indicator will be always on.
- b. The indicator stops flashing, please long press the button for (about 10 seconds) until the indicator enters a flashing status.
- c. Whether the indicator light is flashing or slow flashing, Bluetooth pairing connection can be used.

10

3.3 Open your Haiz Smart app, and a pop-up window named "device to be added:1" will pop up at the bottom, and click "Add".

Note:

If there is no pop-up window in the app interface, just restart the app.

11

3.4 Enter the WiFi account and password, click "NEXT" and wait for the connection to be completed, then click "Done" to complete the connection.

Note:

Wi-Fi only support a 2.4GHz network (802.1 b/g/n).

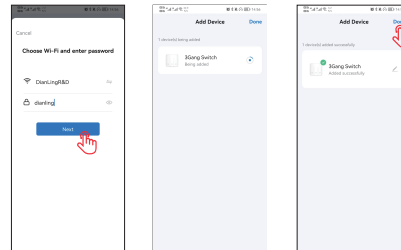

12